

Consumer products

Electrolux

Electrolux implements worldwide 3D factory and material flow planning

Products

Teamcenter, Tecnomatix

Business challenges

Create globally uniform production facilities and assembly processes

Achieve higher efficiency in assembly process and material flow

Develop, test and optimize automation concepts

Combining product development with production planning

Keys to success

Worldwide implementation of Teamcenter for Manufacturing

3D factory planning using Line Designer with central libraries

Robot simulations with Process Simulate

Checking of material flow and train routes, simulation and optimization of assembly processes with Plant Simulation

Results

Saved \$2 million in buffer space and associated investments

Protected plant designs and investments

Ramped-up new plants without errors and delays

With Tecnomatix and Teamcenter, Electrolux creates uniform, efficient manufacturing processes and systems

Globally distributed production facilities

Electrolux AB, based in Stockholm, Sweden, sells appliances for household and commercial use in 150 countries around the world. With around 58,000 employees and 46 production sites, the company develops and manufactures products of numerous brands: in addition to Electrolux, the top brands Grand Cuisine, AEG, Zanussi, Frigidaire and Westinghouse enjoy a particularly high reputation.

In 1996, the German AEG brand was acquired from Daimler Benz, together with several divisions and locations of the group. This is how the factory in Rothenburg ob der Tauber, founded in 1964, came to Electrolux, which today produces 600,000 stoves and 1,400,000 cooking ranges per year for the European market. "We attach great importance to implementing in detail the essential product characteristics of each brand in development and production," reports Bernd Ebert, director of Global Manufacturing Engineering – Food Preparation at Electrolux. Based in Rothenburg, Ebert ensures that all Electrolux cooking appliance factories implement uniform processes and systems.



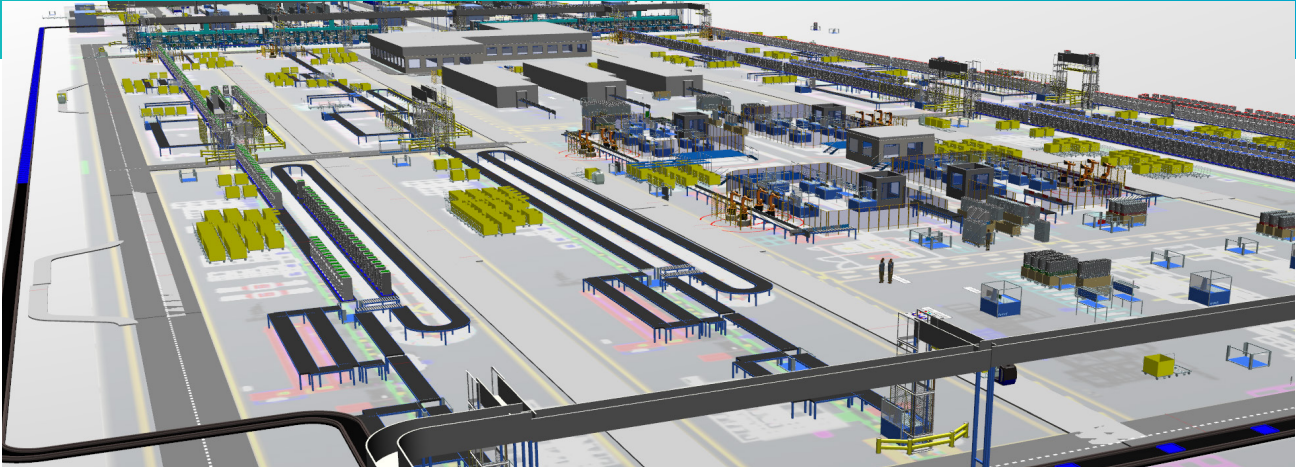

“The factory is too expensive to use as an experimental field. To test new concepts, there are efficient simulation tools that make production downtime superfluous.”

Bernd Ebert
Director of Global
Manufacturing Engineering –
Food Preparation
Electrolux

High priority for virtual factory planning

As part of a comprehensive digitalization strategy covering all areas, 11 digital manufacturing projects are on the agenda of the Swedish global corporation. Ebert has assumed responsibility for two global projects with the highest priority. They aim to create “digital twins” of all manufacturing sites: In the virtual manufacturing project, an advanced planning tool was selected and introduced for early design verification to develop products that are production- and assembly-friendly. For example, assembly sequences and movements will be planned and optimized three-dimensionally to prevent collisions. The prerequisite for this is the development of three-dimensional factory layouts, which is the focus of the second project, 3D factory layout. The layouts will be created using a standard factory

planning tool that can simulate both the plant and the material flow on the basis of 2D data in order to optimize capacity and efficiency.

Global platform for digital manufacturing

Software selection began in 2010, when only a few had powerful software for 3D factory planning. A small, specialist team led by Ebert worked closely with the company’s IT department in Stockholm. Starting in 2012, Teamcenter from Siemens Digital Industries Software was deployed there as a strategically important product development platform for product lifecycle management (PLM) at Electrolux. Discussions about Siemens’ future strategy led to an offer to test a pre-release version of the 3D layout software Line Designer in an early adopter program.

“With the good visualization possibilities of Tecnomatix, I can show the management an early stage of planning that makes the processes plausible.”

Bernd Ebert
Director of Global Manufacturing Engineering – Food Preparation
Electrolux

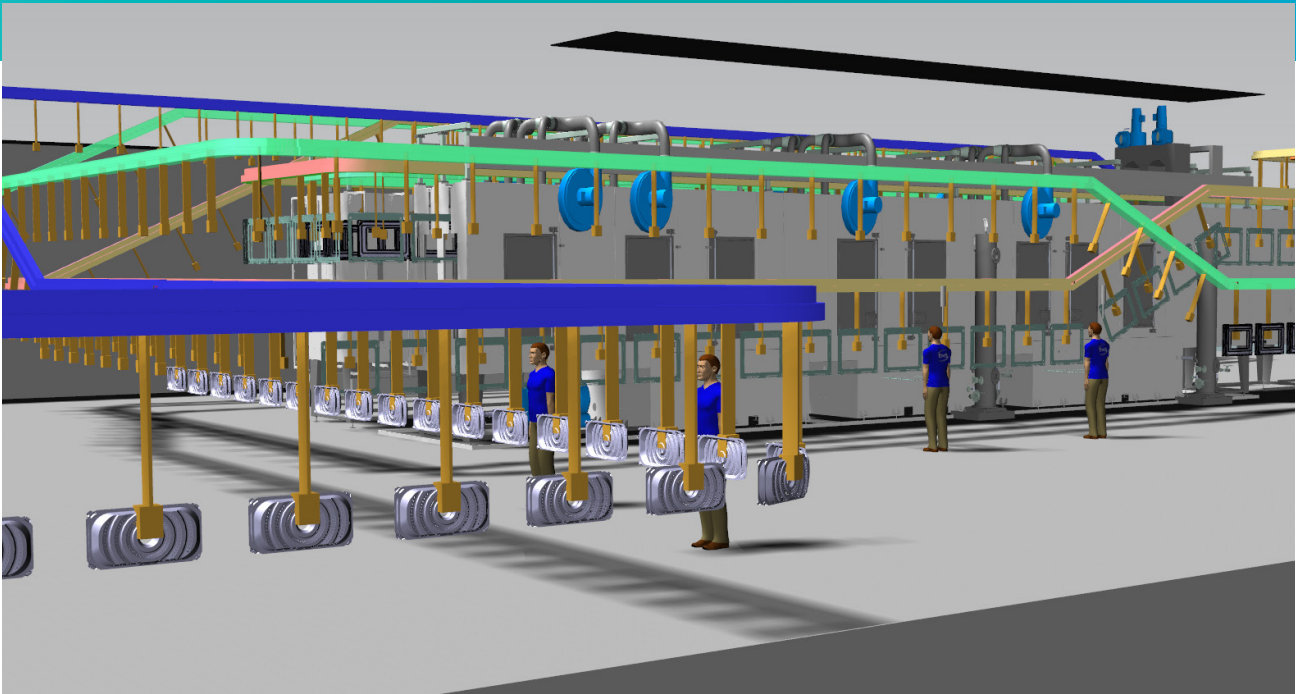

Siemens was given the opportunity to use original data to build a showcase demonstrating the performance of the software on real problems. As a result, in 2016 Line Designer was selected in conjunction with solutions in the Tecnomatix® portfolio, including the Process Simulate solution. The main reasons for this decision were the advantages of a tight Teamcenter integration of these solutions: “We can save all resources created with Line Designer as libraries in Teamcenter, manage them and make them available to all users worldwide,” explains Ebert. “This way we preserve an entire infrastructure of software and hardware including training material and can build on the existing users’ experience with Teamcenter.” The expected results were a close alliance for product development and a global, common platform for factory planning and material flow optimization.

Roll-out strategy after pilot project

In a pilot project carried out in Rothenburg in 2016, employees received training by Siemens and developed, among other things, a new assembly line and automated housing assembly with Line Designer.

“The 3D technology helps with the verification of assembly concepts as well as with the selection of suppliers for automation solutions and provides insights that I didn’t have before.”

Bernd Ebert
Director of Global Manufacturing Engineering – Food Preparation
Electrolux

Ergonomics studies were carried out with Process Simulate and cycle times were successfully optimized using simulations. "The Tecnomatix and Teamcenter solutions have proven themselves in the best way," reports Ebert as project manager. "At the same time, we have gained valuable experience for a worldwide deployment."

The core team has now trained specialists for each of the three software solutions, who can provide advice and support to the decentralized employees at the locations. The system areas created with Line Designer, such as conveyors and lifts, or models of material transport trolleys and other devices, can be parameterized. "By making the 3D models and scenarios available worldwide, we save lots of work," reports Ebert. "After adjusting the parameters, they are simply re-used elsewhere. This brings us almost automatically closer to the desired standardization of processes and systems across the product lines – cooking, washing and dishwashing, drying and cooling/freezing – as well as the sectors USA, South America, Asia/Pacific and Europe."

"Based on the experience gained from the pilot project, the worldwide rollout has now been carried out in waves, each of which includes the intensive training and familiarization of the employees at one location," says Ebert. "In order to secure our major projects, we initially selected four locations with high investment volumes."

Project Anderson, South Carolina

One location involves the complete construction of a new refrigerator factory in Anderson, South Carolina, in which refrigerator production is to be concentrated on the American continent by mid-2019. There, a higher degree of automation should save around 30 percent of human labor. Many processes were planned with Tecnomatix in order to develop a new automation concept, to plan the factory correctly at the first attempt and to secure the immense investment.

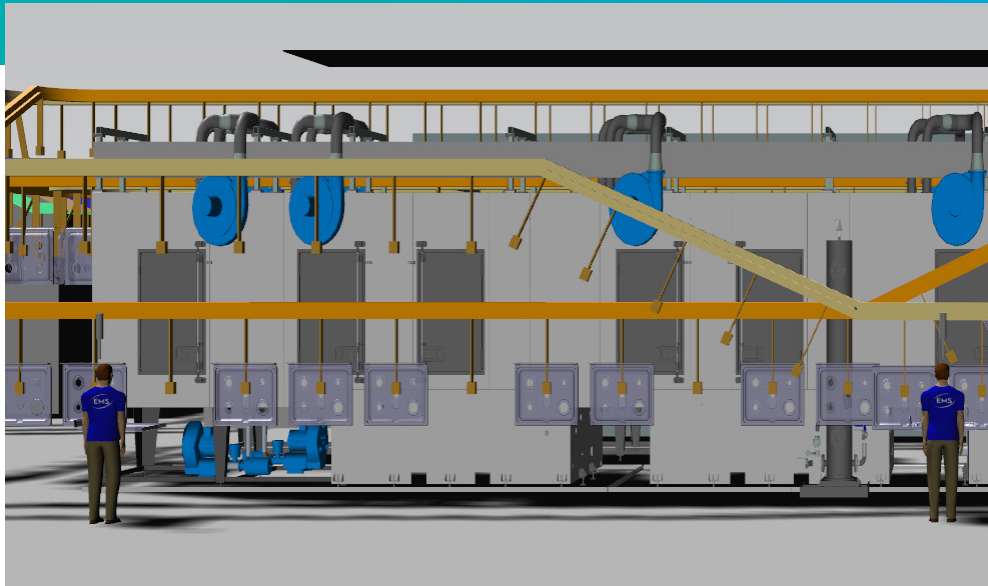

A very time-consuming production area is the plant for foaming the refrigerator walls with hardening. All areas before and after are based on the process times there. In order to design this bottleneck correctly at the first attempt, the process was mapped and simulated as a one-piece flow. "A lot of details had to be taken into account, such as different materials and different models," says Ebert. "To depict all this was very time-consuming, but it was worth it." The accurate results of Plant Simulation eliminate the need for large buffers, saving approximately \$2,000,000 by having one conveyor and one high-bay warehouse for 5,000 refrigerators.

After foaming, the assembly processes branch to four lines. Here, the train routes of the material flows were planned, simulated and optimized with all purchased parts of the parts lists for 30 models of the modular product design that go from the truck to the assembly lines. "An employee of Siemens has laid the foundations for the train routes. But in the meantime our material flow is improved daily by our own employee – we have already achieved our effectiveness targets," reports Ebert.

Solutions/Services

Teamcenter
[siemens.com/teamcenter](https://www.siemens.com/teamcenter)

Line Designer
[siemens.com/line-designer](https://www.siemens.com/line-designer)

Tecnomatix
[siemens.com/tecomatix](https://www.siemens.com/tecomatix)

Customer's primary business

Electrolux AB is a Swedish group in the household and commercial kitchen appliances sector based in Stockholm.
www.electrolux.com

Customer location

Stockholm, Sweden
Rothenburg ob der Tauber, Germany

The accurate results of Plant Simulation eliminate the need for large buffers, saving approximately \$2,000,000 by having one conveyor and one high-bay warehouse for 5,000 refrigerators.

With Process Simulate, the employees also planned robot cells that would take over some of the previously manual processes. "Even if the cells are not yet completely detailed, we can decide with a high degree of certainty whether we need one or three robots," says Ebert. The high planning reliability is conveyed to the management in 3D scenarios and videos.

"A big investment requires a lot of persuasiveness," Ebert asserts. "With the good visualization possibilities of Tecnomatix, I can show the management an early stage of planning that makes the processes plausible. The 3D technology helps with the verification of assembly concepts as well as with the selection of suppliers for automation solutions and provides insights that I didn't have before."

Worldwide deployment concept

The first projects have proved that Tecnomatix and Teamcenter tools can be used to solve tasks and achieve goals. However, the employees deal with the powerful tools regularly. "We need specialists to take on new roles in our global team," Ebert says. "For successful standardization, every topic must be described centrally." Further major projects are now also pending in Europe.

"The factory is too expensive to use as an experimental field," Ebert says, referring to Professor Dr. Hans-Jürgen Warnecke, a well-known scientist and former president of the Fraunhofer Gesellschaft in Germany. "To test new concepts, there are efficient simulation tools that make production downtime superfluous."

"We can save all resources created with Line Designer as libraries in Teamcenter, manage them and make them available to all users worldwide."

Bernd Ebert
Director of Global Manufacturing Engineering – Food Preparation
Electrolux

Siemens Digital Industries Software

Americas +1 314 264 8499
Europe +44 (0) 1276 413200
Asia-Pacific +852 2230 3333

© 2019 Siemens. A list of relevant Siemens trademarks can be found [here](#). Other trademarks belong to their respective owners.
76195-C10 3/19 A

[siemens.com/software](https://www.siemens.com/software)